



# STAR WARS

THE NEW YODA CHRONICLES



**Now Available on DVD**



Visit [DisneyDVD.com](http://DisneyDVD.com)  
Distributed by Walt Disney Studios Home Entertainment, Burbank, CA 91521.  
© 2015 & TM Lucasfilm Ltd. LEGO, the LEGO logo, the Brick and the Knob configurations and the Minifigure are trademarks of the LEGO Group. © 2015 The LEGO Group.



# Space Mission

There are many planets in the *Star Wars* galaxy.  
Find and circle the ones below.

O	N	A	B	O	O	C	X	A	O
F	N	G	E	O	N	O	S	I	S
E	X	I	B	O	A	R	X	A	Y
L	T	A	M	O	O	U	I	T	O
U	L	I	Y	A	O	S	N	H	E
C	N	A	B	L	K	C	T	A	O
I	T	K	J	D	O	A	X	A	T
A	A	Y	B	E	E	N	D	O	R
Z	T	Y	K	R	H	T	O	H	H
Q	O	Y	B	A	O	C	X	A	O
I	O	H	S	A	U	C	M	A	E
A	I	S	A	N	O	C	O	U	S
N	N	A	B	O	G	A	D	A	T
O	E	K	E	O	E	C	X	R	O

# Word Builder

Many words to make, there are. Using the letters below, make as many words as you can and write them on the lines below. Make it interesting and time yourself.  
How many can you make in a minute?

## MASTER YODA

---



---



---



---



---



---



---

EXAMPLES OF POSSIBLE ANSWERS: DAY, MAST, STORE, YESTER, STEM, SHARE, MAY, STEADY, STORY, YES, TRADE, ROAD, TOAD, MADE, MATE, STAY, OYSTER, ASTER, SAW, RAYS, MARE, YET, MODE, RODE, REST, MORE, ADORE, ADS, DESTROY, DATE, ARMED, ROSE, ROASTED, ARTSY, AREAS, DEAR, DREAMS, EATS, DRYEST, MAYOR, MEAT, READY, RATS, SMART, ROAMED, SOMEDAY, TOYS, and more...

# Travel In Style

Before it was Han Solo's ride, it belonged to Lando Calrissian. What fierce freighter can it be? Connect the dots to find out. Then color it!

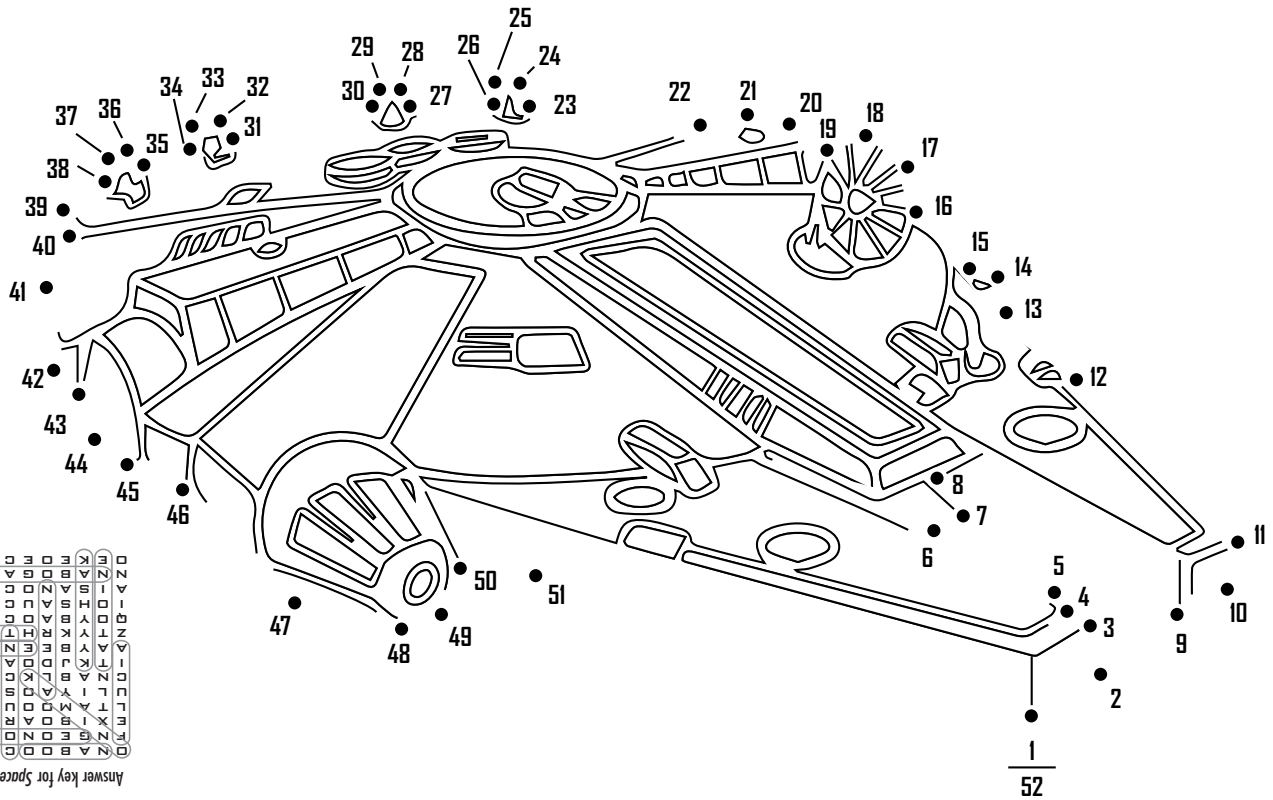

Answer key for Space Mission:

O	N	A	B	O	O	C	X	A	O
F	N	G	E	O	N	O	S	I	S
E	X	I	B	O	A	R	X	A	Y
L	T	A	M	O	O	U	I	T	O
U	L	I	Y	A	O	S	N	H	E
C	N	A	B	L	K	C	T	A	O
I	T	K	J	D	O	A	X	A	T
A	A	Y	B	E	E	N	D	O	R
Z	T	Y	K	R	H	T	O	H	H
Q	O	Y	B	A	O	C	X	A	O
I	O	H	S	A	U	C	M	A	E
A	I	S	A	N	O	C	O	U	S
N	N	A	B	O	G	A	D	A	T
O	E	K	E	O	E	C	X	R	O